

PROTECRSS **COMPOSITE SYSTEM** **COMPOSITE GF SYSTEM**

For flat or low sloped conventional roof assemblies

ModulR insulation technology

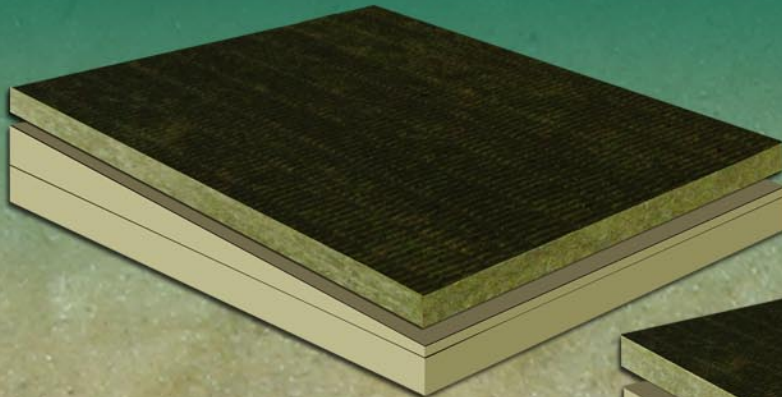

*Available
Tapered
or Flat*

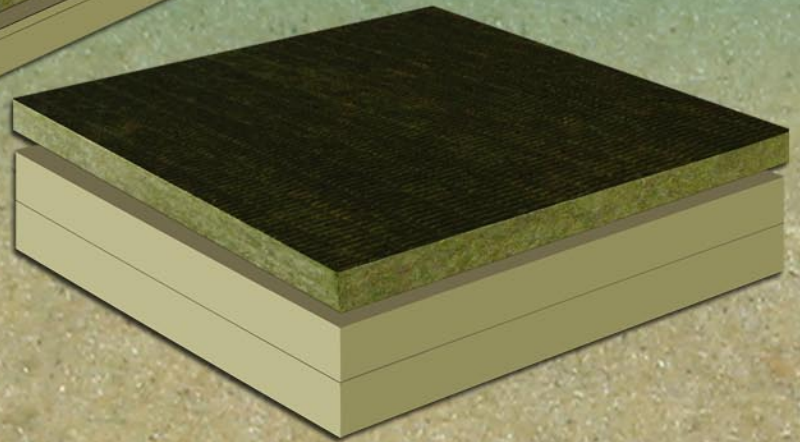

- *Labour saving installation*
- *Non-corrosive to steel decks*
- *Torch safe, fire resistant surface*
- *Available in a variety of thicknesses or "R"-Values*
- *Ideal dimensionally stable substrate for waterproofing membranes*
- *Factory laminated high density stone wool to polyisocyanurate panel(s)*
- *Available in 4' x 4' shiplap edge sheets flat and custom tapered systems*
- *CFC & HCFC free & does not contain or release ozone depleting chemicals*
- *Ready for torched, hot mopped and cold applied mod bit or BUR membrane*
- *Adhered with hot bitumen, cold applied adhesives or with mechanical fasteners*
- *Can be used as an insulated cover board over polyisocyanurate, expanded or extruded insulations*

The closed cell polyisocyanurate foam insulation boards in the GF products are covered with an inorganic glass facer

ModulRTS INC

Developing roofing solutions with everyone in mind

1-800-908-9899 / www.modulrts.com / contact.us@modulrts.com